



Queen's Hill Primary and Nursery School travel plan



Your School travel plan

This travel information plan aims to try and give your staff and customers practical travel information to and from your school to encourage sustainable travel by bus, train, by bike or on foot. Traffic jams and full car parks can cause frustration for lots of commuters. You can help keep Norfolk moving.

Travel TIP: the text can be used in different ways, for example; on your website, intranet, included in staff induction packs or given out to parents and visitors over the phone. We recommend the agreed Travel; Plan is shown on the school website.

Enter School name here:

Queen's Hill Primary School & Nursery

Contact details: Name:

Mike Roughsedge

Address:

Kestrel Avenue
Queens Hill, NR8 5FT

Telephone:

01603746857

Email:

Office@queenshill.norfolk.sch.uk

This person is responsible for this travel plan and updates

Travel information to the school will be provided to:

Staff: v

Parents/carers: v

Visitors: v

Contractors: v

Date created:

February 2017

Date revised*

September 2017

- As a minimum this should be each September and a snapshot mode of travel to school survey each April

Information held within the travel information plan will be reviewed and updated every 6 months. Public transport information can be checked by visiting www.traveline.co.uk

Your School travel plan (cont.)

Information will be provided via;

Website: (essential)

Travel information sheet sent with meeting/appointment invites

Posters:

(school notice board)

Intranet:

Staff training/induction

Hard copies to hand out in school on request

Please provide details of the above:

Travel plan information will be published on the school website and displayed on the notice boards for Parents and stakeholders. The staff induction DVD will cover the key aspects of the travel plan and hard copies will be kept in the office and will be available on request.

The following travel plan events will be promoted;

Walk to Work Week

National Bike Week

World Car Free Day

National Liftshare Week

Local sustainable travel events

School environment events

Total Number of ALL staff at the school* =61

Total number of pupils at the school =403

- This should include part time, ancillary and voluntary support staff

Please provide details of the above:

The above initiatives will be published on the website and in the school newsletters. Texts will be sent to parents.

Your School travel plan (cont.)

A commitment of £ / staff time of hours have been committed annually for promotion of the School Travel Information Plan and sustainable travel.

Location map:

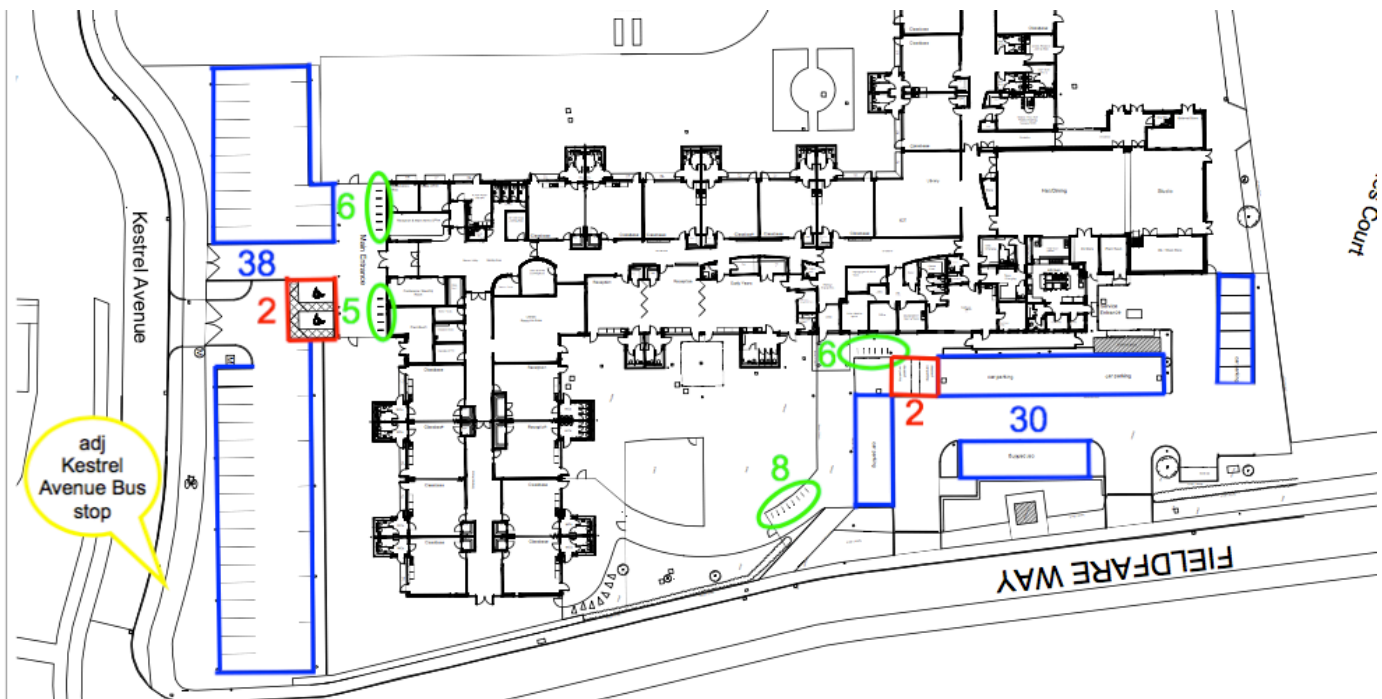

Total number of car parking spaces = 68

Total number of Disable car parking spaces = 4

Total number of Staff bike racks = 4

Total number of child cycle racks = 23

Total number of child scooter parking bars = 0

Amount of covered cycle/scooter parking = 11

Your school travel plan (cont.)

Your local travel options

On foot

Queen's Hill Primary has been built to serve the new village of Queen's Hill currently under construction in West Costessey, west of Norwich city centre. The development is still within the building stage. There are currently three exits to the school, the main one off Kestrel Avenue, secondary on Fieldfare Way and a pedestrian only through the back playground. There are separate pedestrian and vehicular entrances. There is emergency vehicle access to the rear of the building. The school opened in September 2008 for Reception to Y6 children and nursery children started in January 2009. There have been several stages of building works to expand the school. It will officially open with its maximum capacity of 630 in July 2017.

School opens at 8.30am and finish at 3pm. A breakfast club starts at 7.45 a.m. which approximately 30 children attend. There are a variety of after school clubs until approx 4 pm each day.

Stakeholders can walk to school and enter using two main entrances to the side and rear of the school. Parents are encouraged to walk with their children and come into school for the first 10 minutes of each day. Doors are locked at 8.40. Any parents still in the building leave through the front visitors entrance on Kestrel Avenue.

The school is situated approximately 5 miles from the city centre. The closest pub, eatery and supermarket is approximately 1 mile away from the school.

There is a bus stop directly outside the school.



You can plan your journey on foot using walkit.com/norwich

By bike



Children are encouraged to cycle to school. Children in Year 5 receive cycle training funded by the school. Cycles and helmets are provided by the school for children to use during the training if they do not have the correct equipment. The school has ample cycle parking spaces at the side of the school and at the front visitor entrance. If children park at the front visitor entrance they are required to walk to the side or rear entrance. There is also space for adult/staff cycle parking which is covered, adjacent to the kitchen area.

You can plan your journey by bike using www.norwich.cyclestreets.net

Find out more about cycling in Norwich here:

https://www.norwich.gov.uk/info/20187/cycling/1312/cycle_paths

And in Norfolk find out about cycling

<https://www.norfolk.gov.uk/roads-and-transport/alternative-ways-to-travel/cycling>

Your school travel plan (cont.)

By bus



Park and Ride provide a service near to the Norfolk Show Ground which is approximately 4 miles from our school. There is a bus stop directly outside the school. Buses run frequently to and from the bus stop from and to Norwich City centre.

You can plan your journey by bus using www.travelineeastanglia.org.uk

To find out times of the next bus from the bus stop **text** its unique code to **84268**.

Norwich has six **Park & Ride** sites situated around the City providing regular buses direct to the city centre – find out more about Norwich Park & Ride here: <http://www.norwichparkandride.co.uk>

By train



Norwich city train station is located in the city centre. From there a taxi ride takes approximately 30 minutes to our school costing around £13. Alternatively you can catch a bus from the city centre to a bus stop directly outside the school. You could cycle from Norwich train station. This is a distance of 13 miles and would take approximately 41 minutes.

You can plan your journey by train using www.nationalrail.co.uk

By Car



To find us by car enter the following post codes into the SAT NAV system. NR8 5AZ or NR8 5FT. These post codes take you directly to the two main car parks. There is ample parking available. If the car park is full, off road parking is available directly outside the school on Fieldfare way. There are no permit restrictions. Just avoid the yellow lines.

You can find out how many spaces are available at Norwich city centre and Park & Ride car parks using this website: travelnorfolk.norfolk.gov.uk/public/carparks.htm or view the Norwich Parking Planner here: www.norwich.gov.uk/TransportAndStreets/Parking/Documents/Parkingplanner.pdf

Your school travel plan (cont.)

Travel tips

Be aware that we are very close to the Norfolk Showground. Traffic can build and get congested on Norfolk show day in June. Ensure you leave plenty of time on these days.

Have you got a smart phone? Why not try these FREE apps

Nextbuses

Bus Scout (Android only)

BikeHub

WalkIt

Download from Google Play or the App Shop

Traveline

travelineeastanglia.co.uk 0871 200 22 33

National Rail Enquiries nationalrail.co.uk 08457 48 49 50

Cyclestreets

cyclestreets.net

Norfolk Liftshare

norfolk.liftshare.com

Norfolk Car Club norfolkcarclub.com 08456 028 030

Active Norfolk activenorfolk.org 01603 732333

Park and Ride norwichparkandride.co.uk 01362 851210

Anglianbus anglianbus.co.uk 01502 711 109

Coach Services coachservicesltd.com 01842 821 509

First Bus firstgroup.com/norwich 08456 020 121

Konectbus konectbus.co.uk 01362 851 210

Norfolk Green norfolkgreen.co.uk 01553 776 980

Sanders Coaches sanderscoaches.com 01263 712 800

Simonds simonds.co.uk 01379 647 300

Any additional useful information: